



Instruction Manual

Super 88







Model No. 2488, 2489, 2488EX, 2489EX



GOLD MEDAL[®] PRODUCTS CO.

10700 Medallion Drive, Cincinnati, Ohio 45241-4807 USA

SAFETY PRECAUTIONS

	<p>⚠ DANGER</p> <p>Machine must be properly grounded to prevent electrical shock to personnel. Failure to do so could result in serious injury, or death. Do NOT immerse any part of this equipment in water. Do NOT use excessive water when cleaning. Keep cord and plug off the ground and away from moisture. Always unplug the equipment before cleaning or servicing.</p> <p>008GEND1112</p>
	<p>⚠ DANGER</p> <p>Improper installation, adjustment, alteration, service or maintenance can cause property damage, injury or death. Any alterations to this equipment will void the warranty and may cause a dangerous condition. NEVER make alterations to this equipment. Read the Installation, Operating, and Maintenance Instructions thoroughly before installing, servicing, or operating this equipment. Make sure all machine switches are in the OFF position before plugging the equipment into the receptacle.</p> <p>014GEND1112</p>
	<p>⚠ WARNING</p> <p>To avoid burns, do NOT touch the kettle or any heated surface. Do NOT place or leave objects in contact with heated surfaces.</p> <p>013PW1112</p>
	<p>⚠ WARNING</p> <p>ALWAYS wear safety glasses when servicing this equipment.</p> <p>010GENW1112</p>
	<p>⚠ CAUTION</p> <p>Do NOT allow direct contact of this equipment by the public when used in food service locations. Only personnel trained and experienced in the equipment operation may operate this equipment. Carefully read all instructions before operation.</p> <p>012GENC1112</p>
	<p>⚠ CAUTION</p> <p>This machine is NOT to be operated by anyone under the age of 18.</p> <p>007GENC1112</p>

NOTE: Improvements are always being made to Gold Medal's equipment. This information may not be the latest available for your purposes. It is critical that you call Gold Medal's Technical Service Department at 1-800-543-0862 for any questions about your machine operations, replacement parts, or any service questions. *(Gold Medal Products Company does not assume any liability for injury due to careless handling and/or reckless operation of this equipment.)*



INSTALLATION INSTRUCTIONS

Inspection of Shipment

After unpacking, check thoroughly for any damage which may have occurred in transit. Claims should be filed immediately with the transportation company. The warranty does not cover damage that occurs in transit, or damage caused by abuse, or consequential damage due to the operation of this machine, since it is beyond our control.

Setup

Your new Popper was assembled and tested at the factory. Remove all packing material and tape before starting operation.

Accessories Included With Your Machine

- Corn Measure Cup
- Flavacol Cup
- Stamped Aluminum Scoop
- Oil Measure Cup.

Electrical Requirements

The following power supply must be provided for your machine:

2488: 120V, 1525W, 60Hz

2489: 120V, 1605W, 60Hz

2488EX: 230V, 1562W, 50Hz

2489EX: 230V, 1570W, 50Hz

	⚠ DANGER
	<p>Machine must be properly grounded to prevent electrical shock to personnel. Failure to do so could result in serious injury, or death.</p> <p>Do NOT immerse any part of this equipment in water.</p> <p>Do NOT use excessive water when cleaning.</p> <p>Keep cord and plug off the ground and away from moisture.</p> <p>Always unplug the equipment before cleaning or servicing.</p>

Your electrician must furnish sufficient power for proper machine operation. We recommend this popper be on a dedicated and protected circuit. Failure to wire properly will void the warranty and may result in damage to the machine. It is Gold Medal Products Company's recommendation that this machine be plugged directly into a wall outlet. The use of extension cords is not recommended due to safety concerns, and may cause sacrificed and/or reduced performance.

Before You Plug In Machine

1. Make sure all machine switches are in the OFF position before plugging the equipment into the receptacle.
2. Make sure the wall outlet can accept the grounded plugs (where applicable) on the power supply cord.
3. The wall outlet must have the proper polarity. If in doubt, have a competent electrician inspect the outlet and correct if necessary.
4. **DO NOT** use a grounded to un-grounded receptacle adapter.
5. Install the unit in a level position.

OPERATING INSTRUCTIONS

Controls and their Functions

LIGHT AND WARMER SWITCH

Turns on the heat to the bottom corn pan and heat light.

KETTLE MOTOR SWITCH

Turns on the motor which drives the kettle agitator.

KETTLE HEAT SWITCH

Supplies power to the thermostat controlled kettle.

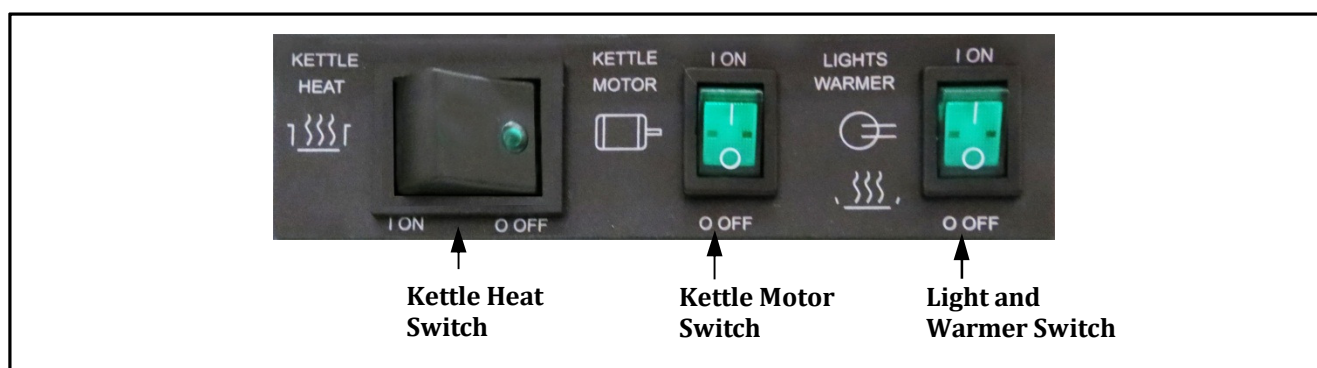

Amount of Popcorn and Oil

Your new Popper is equipped with a corn measuring cup. Popcorn popped in coconut oil stays fresher longer. Coconut oil does not leave black deposits in your kettle like other oils.

Corn charge – 8.0 oz.

Oil charge – 2.0 oz.

Flavacol – 1 tablespoon

Popping Instructions

1. Turn the Kettle Heat and Kettle Motor Switch on.
2. Make a test pop with 3 kernels of corn and 2.0 oz. of oil.
3. Turn on the kettle and let it pre-heat for 5 to 8 minutes.
4. Load pre-measured popcorn and oil into kettle.
5. When corn has finished popping, dump the kettle.
6. Repeat cycle starting with #4.
7. Turn kettle heat and motor off when finished popping corn.

CARE AND CLEANING

Kettle Daily Cleaning

1. Each time you finish a series of popping, allow the kettle to cool down and wipe the outside of the kettle with a soft cloth to remove any oil drippings left behind.
2. After you finish popping for the day, allow the kettle to cool until it is not too hot to handle, but still warm.
3. Unplug the kettle and remove it from the machine.
4. With a cloth, wipe out the inside of the kettle, kettle lid, crossbar, outside and underneath of the kettle.

DO NOT place the kettle in water. This will cause damage to the electrical components and will void your warranty.

Cabinet Daily Cleaning

Cleaning the cabinet of your machine is easy. Take a clean cloth and wipe excess grease from the glass. Wipe the outside of the machine also.

DO NOT use a glass or plastic cleaner that contains ammonia, it will crack the plastic on the machine.

	<p style="text-align: center;">⚠ DANGER</p> <p>Machine must be properly grounded to prevent electrical shock to personnel. DO NOT immerse in water. Always unplug the equipment before cleaning or servicing.</p>
---	--

Good sanitation practice demands that all food preparation equipment be cleaned regularly. A clean looking, well-kept machine is one of the best ways of advertising your product.



MAINTENANCE INSTRUCTION



⚠ DANGER

Improper installation, adjustment, alteration, service, or maintenance can cause property damage, injury or death. Read the installation, Operating, and Maintenance Instructions thoroughly before installing or servicing this equipment.



⚠ DANGER

Do Not immerse the equipment in water. Unplug your machine before servicing.



⚠ WARNING

Adequate eye protection must be used when servicing this equipment to prevent eye injury.



⚠ CAUTION

THE FOLLOWING SECTIONS OF THIS MANUAL ARE INTENDED ONLY FOR QUALIFIED SERVICE PERSONNEL WHO ARE FAMILIAR WITH ELECTRICAL EQUIPMENT. THESE ARE NOT INTENDED FOR THE OPERATOR.



ORDERING SPARE PARTS

1. Identify the needed part by checking it against the photos, illustrations, and/or parts list.
2. When ordering, please include part number, part name, and quantity needed.
3. Please include your model number, serial number, and date of manufacture (located on the machine nameplate) with your order.
4. Address all parts orders to:

Parts Department
Gold Medal Products Co.
10700 Medallion Drive
Cincinnati, Ohio 45241-4807

Or, place orders by phone or online:

Phone: (800) 543-0862

(513) 769-7676

Fax: (800) 542-1496

(513) 769-8500

E-mail: info@gmpopcorn.com

Web Page: www.gmpopcorn.com



Kettle Assembly - 61054N (Domestic), 61054EX (Export)

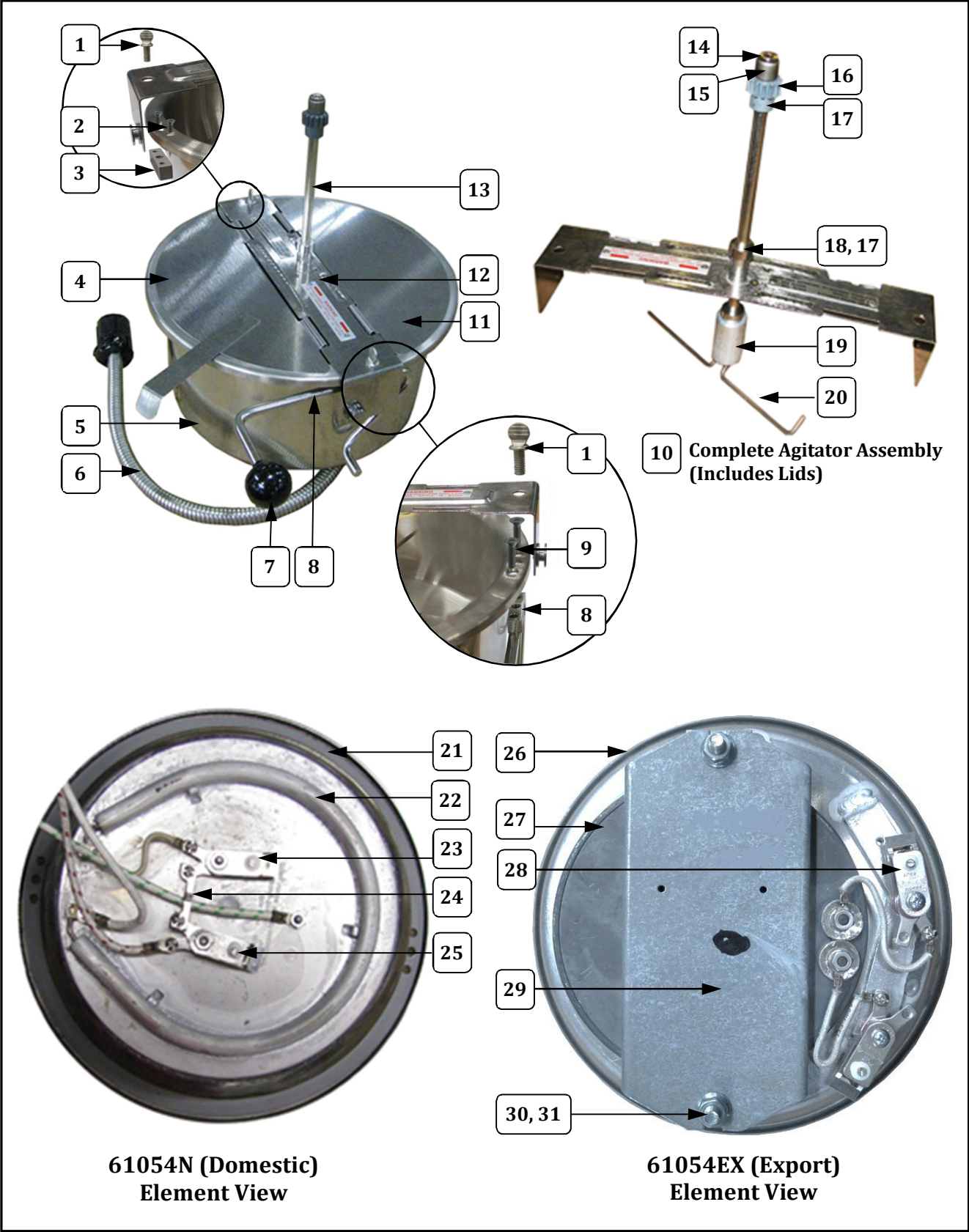



Kettle Assembly – Parts List

61054N –Used for Model Nos. 2488, 2489 (Domestic)

61045EX – Used for Model Nos. 2488EX, 2489EX (Export)

Item	Part Description	Qty.	Part Number	
			61054N	61054EX
1	THUMB SCREW	2	61059	61059
2	8-32 X 1/2 PHILL FLAT M/S ZINC	2	20066	20066
3	BLOCK SHELL AND KETTLE	1	61013	61013
4	FORMED LID (Front Kettle Lid w/Lid Lifter)	1	47261	47261
5	8 OZ KETTLE SHELL	1	61017	61017
6	KETTLE LEAD ASSEMBLY	1	61053	61030
7	KNOB, DUMP HANDLE	1	47110	47110
8	DUMP HANDLE BLOCK WELD	1	88769	88769
9	8-32 X 1 PHILL FLAT M/S ZINC	2	20068	20068
10	8 OZ LID & AGITATOR ASSY (Complete Assembly)	1	61055N	61055EX
11	KETTLE REAR LID	1	47119	47119
12	CROSSBAR ASSEMBLY	1	61010	61010EX
13	AGITATOR SHAFT	1	69712	69712
14	AGITATOR BEARING HUB	1	43434	43434
15	NEEDLE BEARING	1	47106	47106
16	SPUR GEAR	1	47060	47060
17	SET SCREW #10-32 X 3/16	4	41742	41742
18	SET COLLAR 5/16 ID 5/8 OD	3	46649	46649
19	AGITATOR WEIGHT	1	69715	69715
20	STIR ROD	1	69714	69714
BOTTOM VIEW / ELEMENT VIEW				
21	8 OZ KETTLE GASKET	1	61012	61012
22	8 OZ KETTLE AND ELEMENT	1	61280	
23	482°F THERMOSTAT	1	76708	
24	THERMOSTAT SHUNT BAR	1	47193	
25	550°F THERMOSTAT	1	77108	
26	8 OZ KETTLE WELDMENT	1		61019
27	HEAT ELEMENT 240V, 1350W	1		47672
28	450°F THERMOSTAT	2		76089
29	RETAINER BRACKET, ELEMENT	1		49310
30	BOLT 5/16-18 X 3/4 SQHD	2		49446
31	5/16-18 SERRATED LOCK NUT	2		49317

Cabinet Breakdown - Exterior

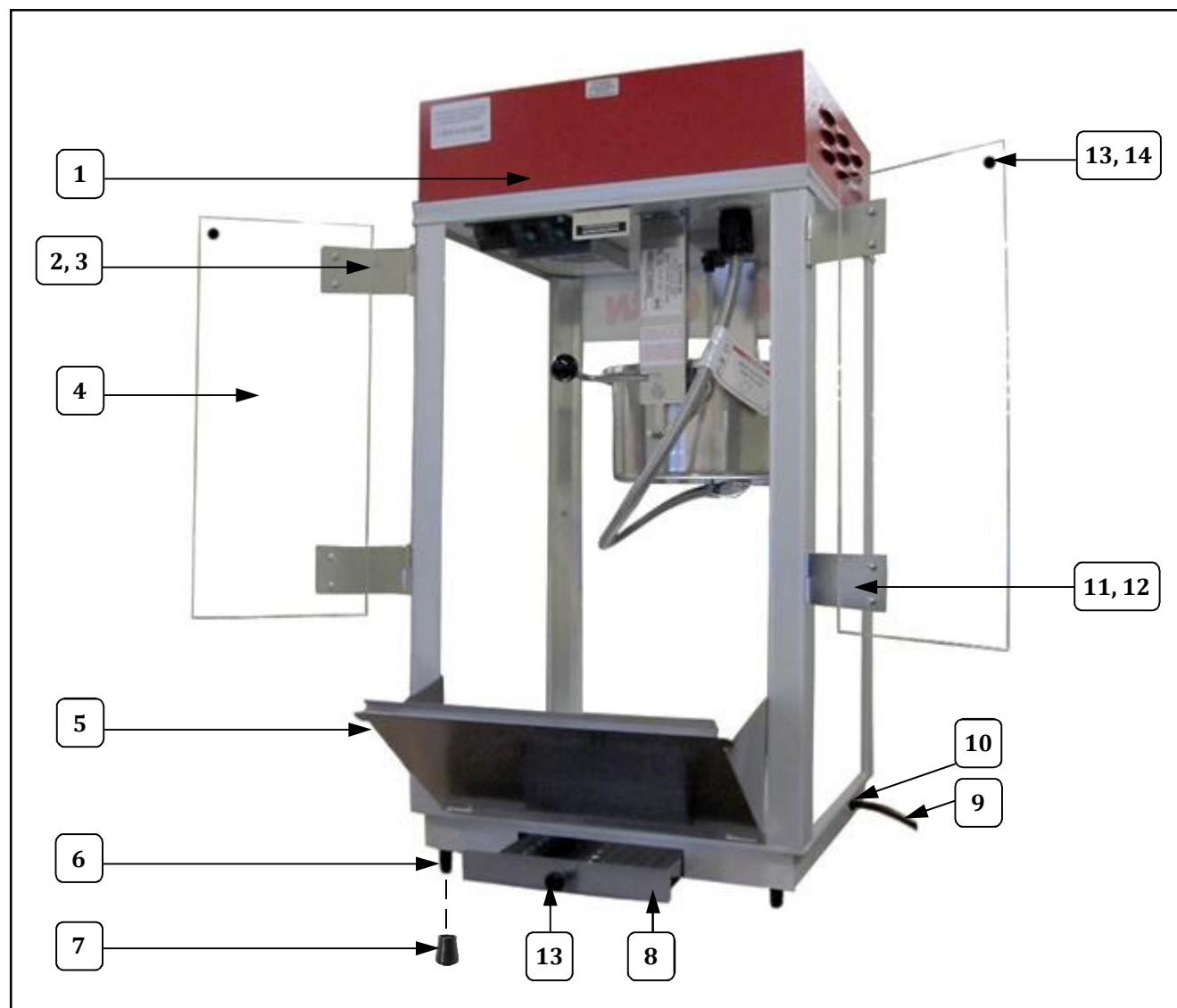

Item	Part Description	Qty.	Part Number			
			2488	2489	2488EX	2489EX
1	DOMED RED	1	49456	59065	49456	59065
2	MALE HINGE SHORT LEFT	2	41349	41349	41349	41349
3	FEMALE HINGE LONG LEFT	2	41352	41352	41352	41352
4	PLEXIGLASS DOOR	2	61033	61033	61033	61033
5	DROP PANEL	1	49210	49210	49210	49210
6	GLIDE	4	47328	47328	47328	47328
7	CRUTCH TIP	4	49123	49123	49123	49123
8	OLD MAID PAN	1	49100	49100	49100	49100
9	LEAD-IN CORD	1	22038	22038	42369	42369
10	STRAIN RELIEF	1	76026	76026	76026	76026
11	MALE HINGE SHORT RIGHT	2	41350	41350	41350	41350
12	FEMALE HINGE LONG RIGHT	2	41351	41351	41351	41351
13	KNOB LID LIFT	3	47120	47120	47120	47120
14	TEE BOLT	2	75267	75267	75267	75267



Cabinet Breakdown - Interior



Item	Part Description	Qty.	Part Number			
			2488	2489	2488EX	2489EX
1	CORN PAN	1	49211	49211	49211	49211
2	GLASS RETAIN STRIP, FRONT	1	61038	61038	61038	61038
3	GLASS RETAIN STRIP, REAR	2	61037	61037	61037	61037
4	GLASS STRIP	1	61039	61039	61039	61039
5	GLASS STRIP COVER	1	61040	61040	61040	61040
6	HEAT ELEMENT	1	40031	40031	40113	40113
7	STRIP HEATER BRACKET	1	49425	49425	49425	49425
8	OLD MAID PAN	1	49100	49100	49100	49100
9	WIRING GUARD	1	49201	49201	49201	49201

Cabinet Breakdown - Interior

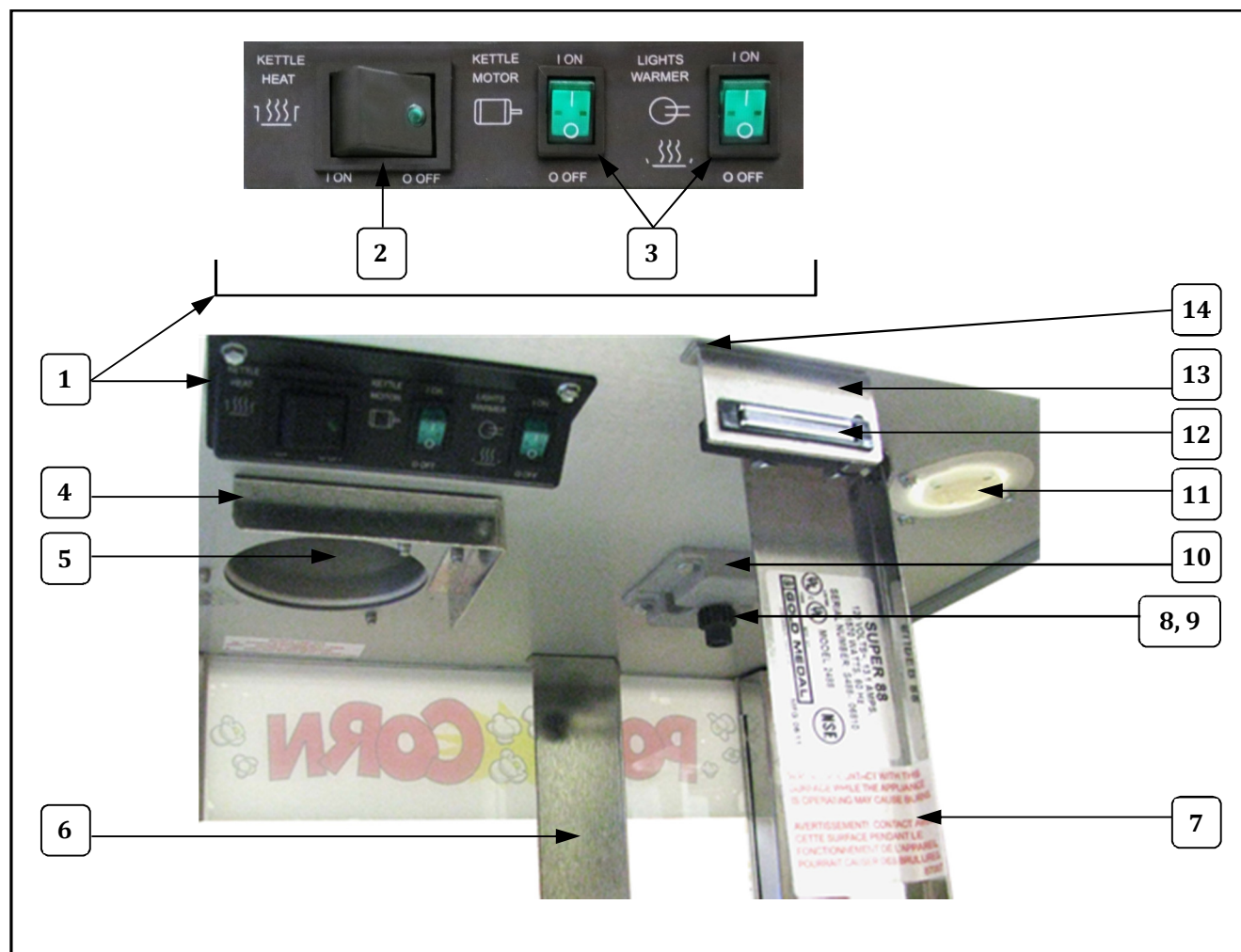

Item	Part Description	Qty.	Part Number			
			2488	2489	2488EX	2489EX
1	SMALL SWITCH BOX	1	48501	48501	48501	48501
2	LIGHTED ROCKER SWITCH	1	42798	42798	42798	42798
3	DPST ROCKER SWITCH	2	42532	42532	42532	42532
4	LIGHT SHIELD ANGLE	1	47799	47799		
5	65W REFLECTOR FLOOD - Light Bulb	1	41671	41671		
	75W HALOGEN FLOOD 240V-Light Bulb	1			41979EX	41979EX
6	REAR HANGER ARM	1	61050	61050	61050	61050
7	FRONT HANGER ARM	1	61049	61049	61049	61049
8	SPUR GEAR	1	47060	47060	47060	47060
9	SET SCREW 10-32 X 3/16	1	41742	41742	41742	41742
10	GEAR BLOCK ASSEMBLY	1	67194NM	67194NM	67194NM	67194NM
11	KETTLE RECPT	1	49330	49330	49330	49330
12	MAGNETIC CATCH	1	47561	47561	47561	47561
13	MAGNETIC CATCH MT BRKT	1	77089	77089	77089	77089
14	MAGNETIC BRACKET SHIM	1	38527	38527	38527	38527



Dome Interior - Electrical Breakdown

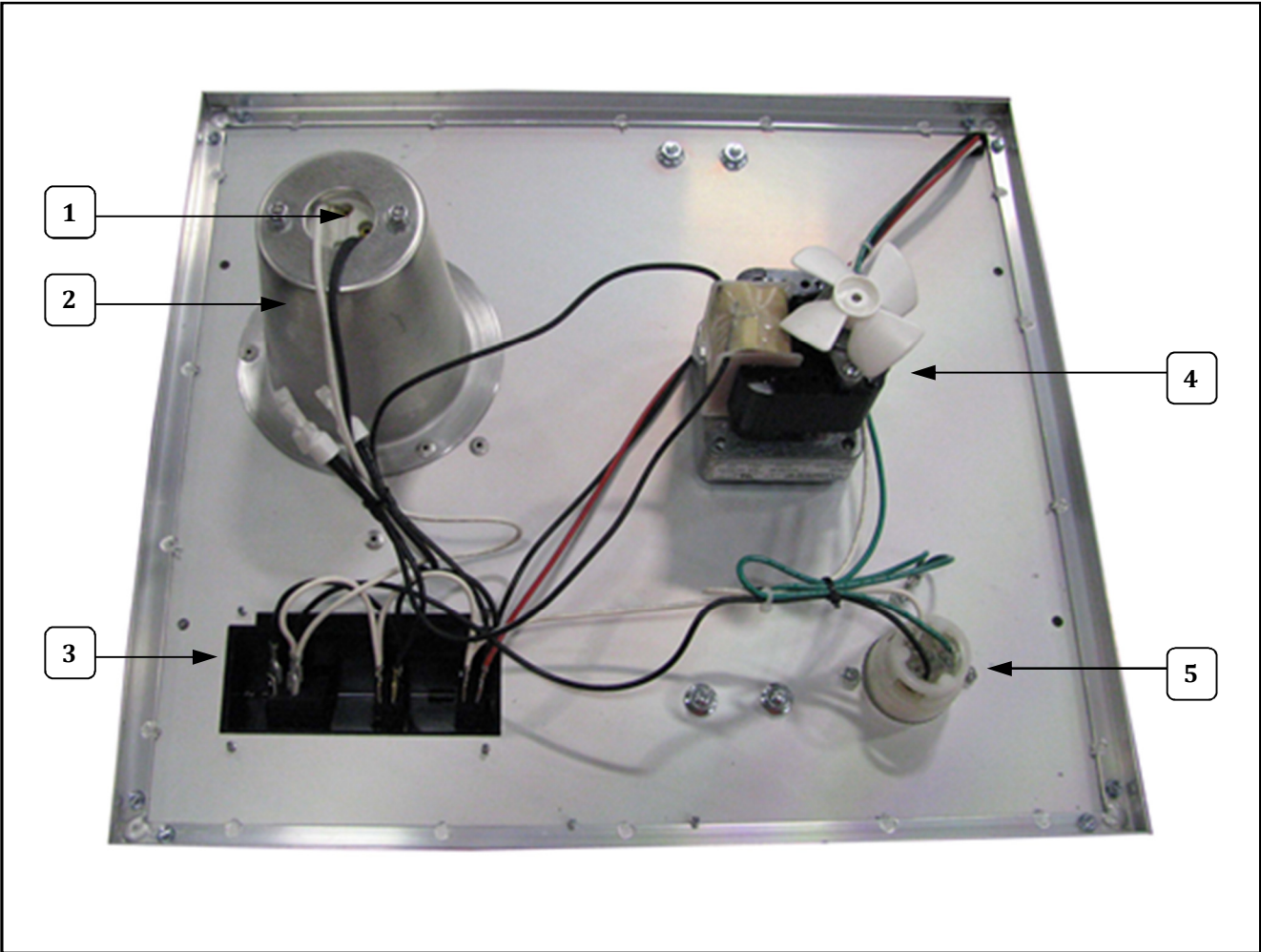

Item	Part Description	Qty.	Part Number			
			2488	2489	2488EX	2489EX
1	LAMP HOLDER	1	47047	47047	47047	47047
2	LIGHT SHIELD CONICAL	1	49480	49480	49584	49584
3	SMALL SWITCH BOX	1	48501	48501	48501	48501
4	KETTLE DRIVE MOTOR	1	47038	47038	47067	47067
5	KETTLE RECPT	1	49330	49330	49330	49330



Dome Lighting Breakdown – Model 2489 and 2489EX



Item	Part Description	Qty.	Part Number	
			2489	2489EX
1	POPCORN SIGN	1	49575	49575
2	DOMED RED	1	59065	59065
3	FLUORESCENT TUBE LOCK	2	12502	12502
4	LIGHT TUBE HOLDER STARTER	1	41021	41021
5	LIGHT STARTER	1	41023	41023
6	LIGHT BALLAST	1	41022	41722
7	MOLDED PLUG	1	47726	47726
8	LIGHT TUBE HOLDER	1	41020	41020
9	LIGHT TUBE	1	41057	41057

Accessories



Item	Part Description	Qty.	Part Number			
			2488	2489	2488EX	2489EX
1	MEASURE ONE CUP	1	47147	47147	47147	47147
2	MEASURE 6.5CC (Flavacol Cup)	1	47678	47678	47678	47678
3	OIL MEASURE (1/3 CUP)	1	47150	47150	47150	47150
4	STAMPED ALUMINUM SCOOP	1	2071	2071	2071	2071

WIRING DIAGRAM

Model No. 2488 and 2489

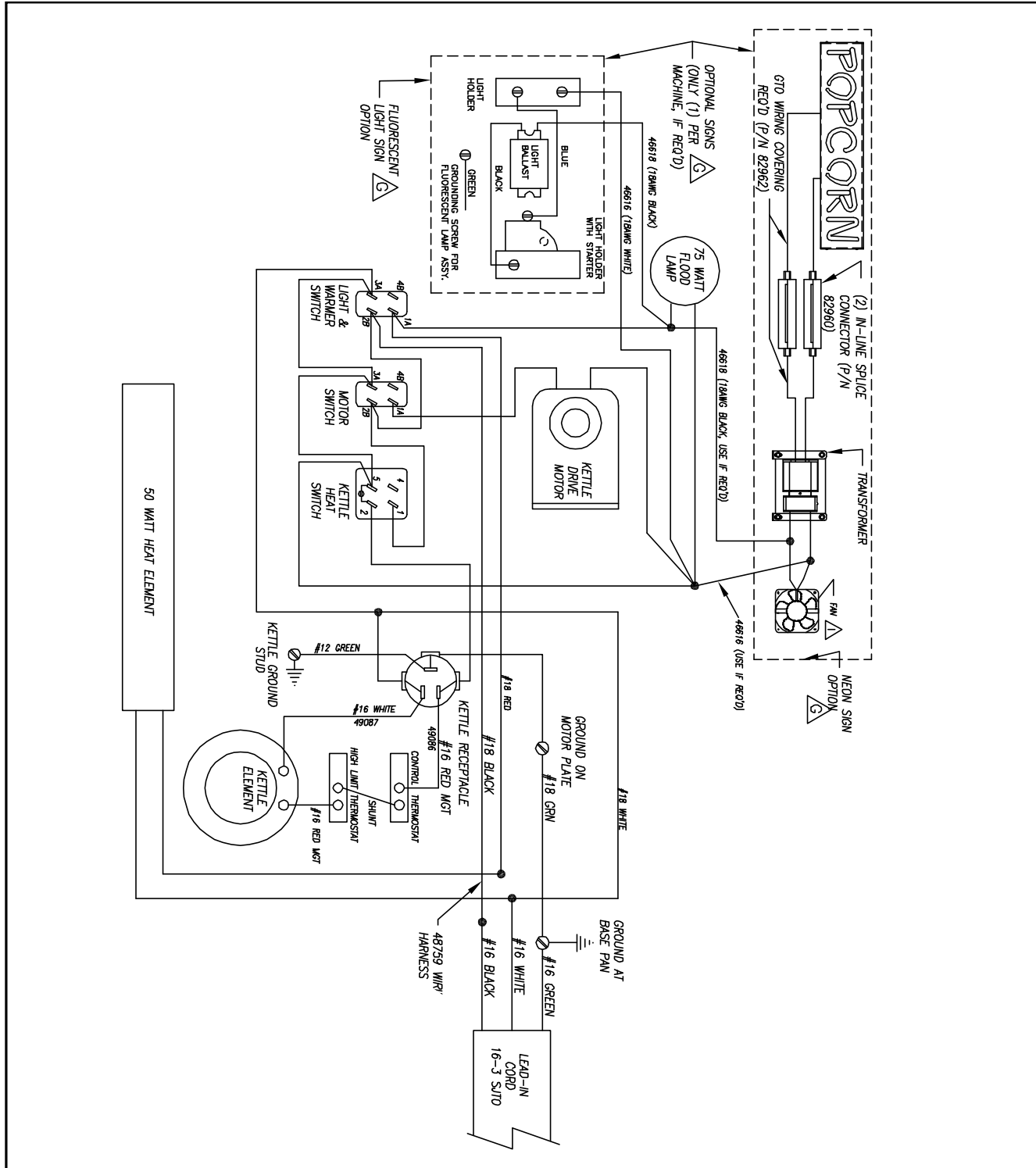

Model No. 2488EX and 2489EX

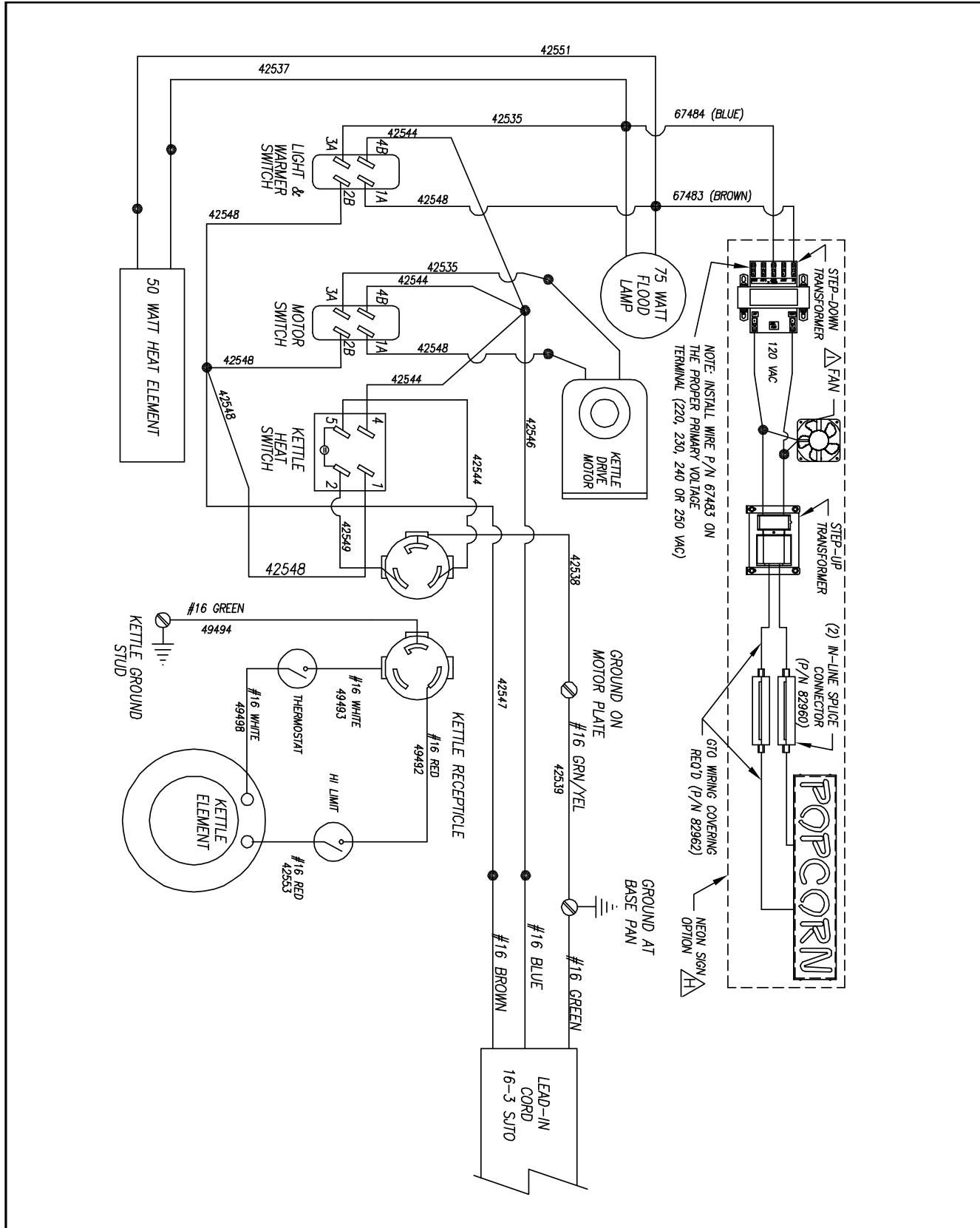



WARRANTY

WE WARRANT to the original purchaser the Gold Medal equipment sold by us to be free from defects in material or workmanship under normal use and service. Our obligation under this warranty shall be limited to the repair or replacement of any defective part for a period of six (6) months from the date of sale to the Original Purchaser with regard to labor and two (2) years with regard to parts and does not cover damage to the equipment caused by accident, alteration, improper use, voltage, abuse, or failure to follow instructions.

THIS WARRANTY IS IN LIEU OF ALL OTHER WARRANTIES EXPRESSED OR IMPLIED, AND OF ALL OTHER OBLIGATIONS OR LIABILITIES ON OUR PART, INCLUDING THE IMPLIED WARRANTY OF MERCHANTABILITY. THERE ARE NO WARRANTIES WHICH EXTEND BEYOND THE DESCRIPTION ON THE FACE HEREOF. We neither assume, nor authorize any other person to assume for us, any other obligation or liability in connection with the sale of said GOLD MEDAL equipment or any part thereof.

The term "Original Purchaser" as used in this warranty shall be deemed to mean that person, firm, association, or corporation who was billed by the GOLD MEDAL PRODUCTS COMPANY, or their authorized distributor for the equipment.

THIS WARRANTY HAS NO EFFECT AND IS VOID UNLESS THE ORIGINAL PURCHASER FIRST CALLS GOLD MEDAL PRODUCTS COMPANY AT 1-800-543-0862 TO DISCUSS WITH OUR SERVICE REPRESENTATIVE THE EQUIPMENT PROBLEM, AND, IF NECESSARY, FOR INSTRUCTIONS CONCERNING THE REPAIR OR REPLACEMENT OF PARTS.

NOTE: This equipment is manufactured and sold for commercial use only.



GOLD MEDAL[®] PRODUCTS CO.

10700 Medallion Drive, Cincinnati, Ohio 45241-4807 USA

www.gmpopcorn.com

Phone: (800) 543-0862
(513) 769-7676

Fax: (800) 542-1496
(513) 769-8500